

Step 1:

Select a position for the fitting. Make sure that the surface is dry and free of dust.

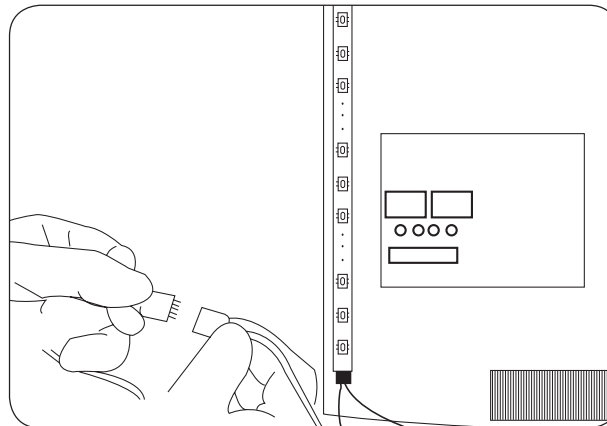
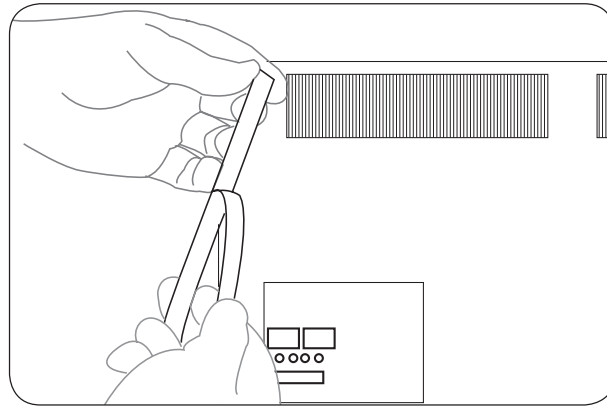

Step 2:

Peel the self adhesive protect layer off the strips and carefully stick strips to the surface.

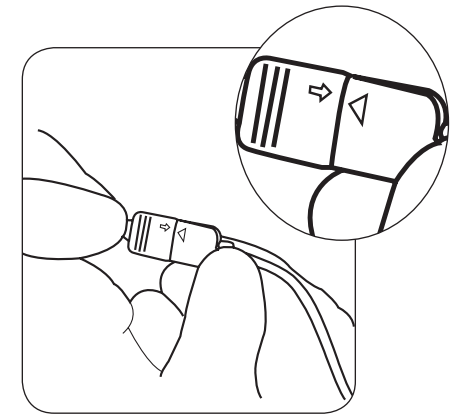
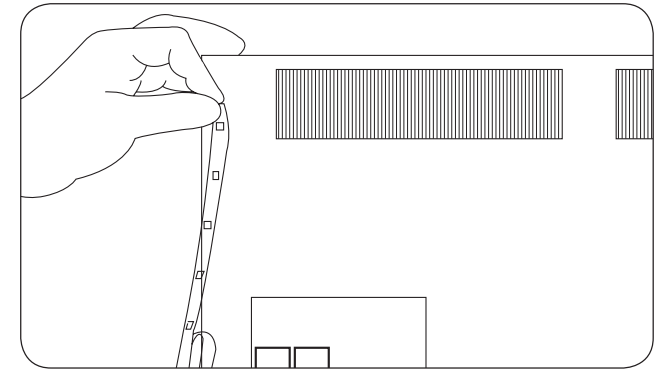
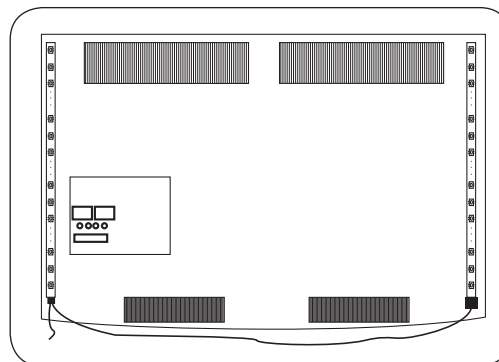

Step 3:

Connect strips to the control unit. Make sure the key marks are matched on both sides.

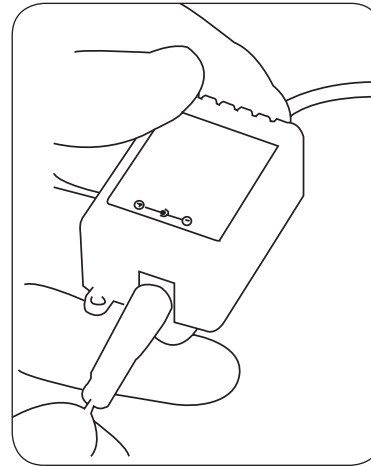
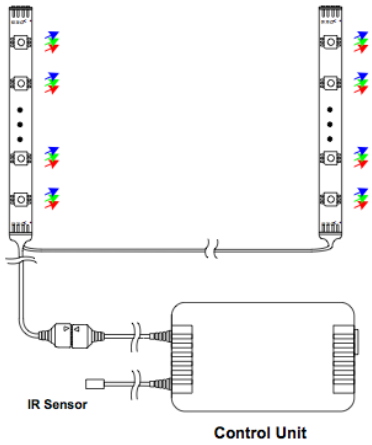

Ambient “Jumbo” connection #1 and #2

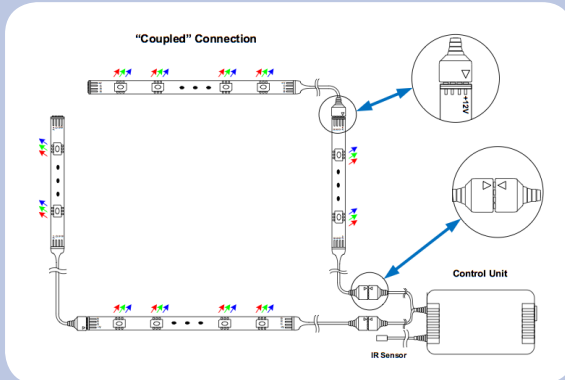
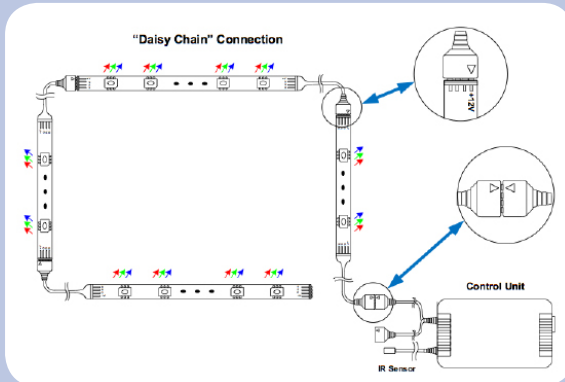

Step 4:

Plug the DC connector to the control unit

Step 5:

Plug power adapter into the wall outlet

If you are still not comfortable with the process please contact us:
help@volkalighting.com.au

**Ambient Light
 for TV and Home Theater**